

O150 | OBSTACLE MARKING TAPE

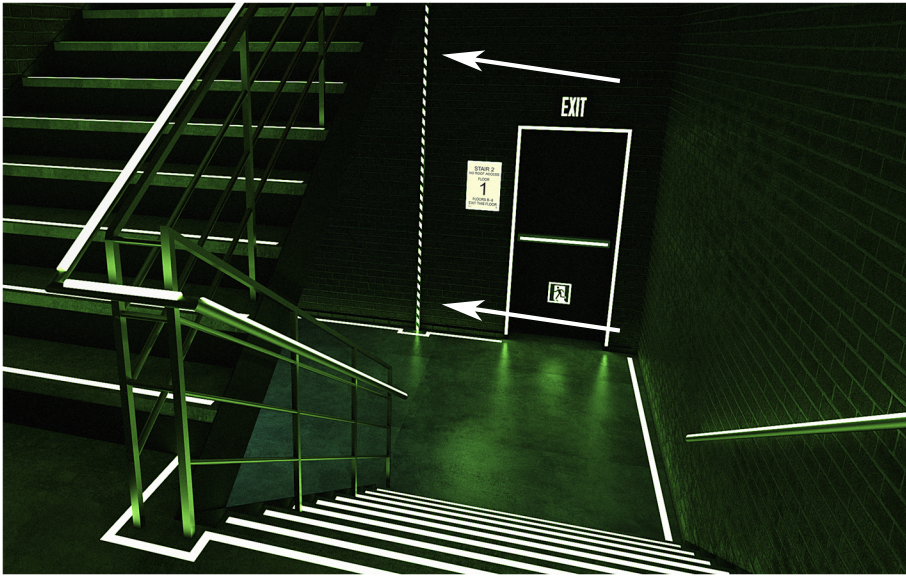

Exit Path/Final Exit Marking

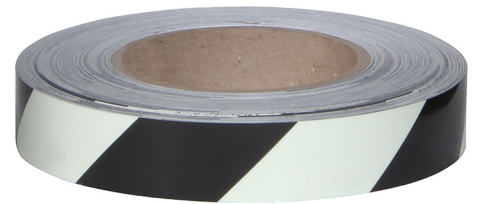
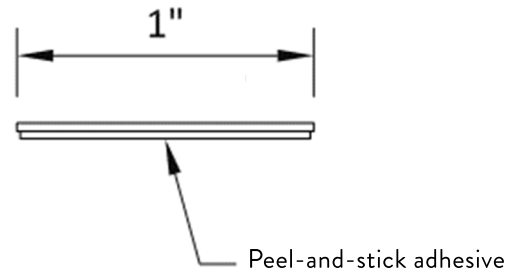

Acrylic obstacle marking tape is chip resistant. 45 degree alternating black and photoluminescent stripes.

- NYC compliant
- Easy peel-and-stick application
- 1" x 150' roll
- Activated by natural, fluorescent, incandescent, or LED light
- Unlimited recharging
- Smooth, easy-to-clean surface
- Cuts with scissors

For exit path/obstacle markings used in:

- High Rise Buildings
- Hospitals
- Assisted Living
- Stadiums
- Schools
- Commercial Buildings

Code Compliant in all 50 states and Canada:

Exceeds ASTM E2072 glow requirements

Code compliant: ICC/IBC/IFC

UL 1994 listed 

5-Year Warranty

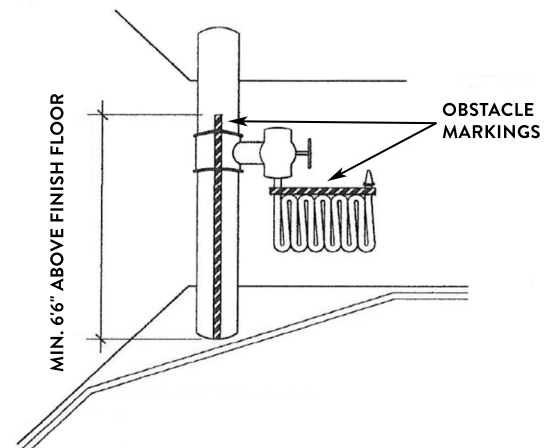
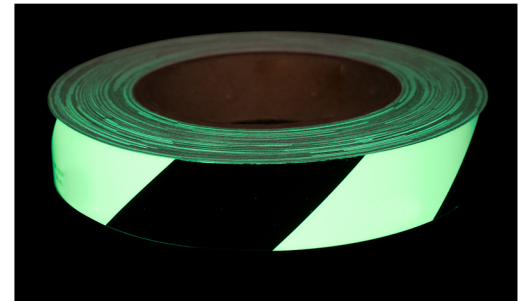

Safe-T-Nose®
LEAVE NO DOUBT • THIS WAY OUT • EXIT SAFELY

WWW.SAFETNOSE.COM • 855-723-6673